



▲ 38.152.81



Flush pull latches large

AISI 316

Snap lock with spring handle. Mirror-polished AISI 316 stainless steel.

Code	Lock	Accepts thicknesses mm	External Ø mm	Recess Ø mm	Depth mm
38.152.80	no	7 - 19	75	63	40
38.152.81	Yes	7 - 19	75	63	40



20.366.98 Spare key for 38.152.81.



OSCULATI



▲ 38.163.01



▲ 38.163.02

Eclipse PUSH LOCK pull latch (push closure)

EXTRA LARGE HANDLE

Featuring an extremely easy grip:
 - 316 mirror-polished stainless steel;
 - Flush deck design.
 - large ergonomic handle;
 - Spring retractable handle.
 - It opens from inside and outside.

Code	Lock	Accepts thicknesses mm	External Ø mm	Recess Ø mm
38.163.01	no	9-19	60	50
38.163.02	Yes	9-19	60	50

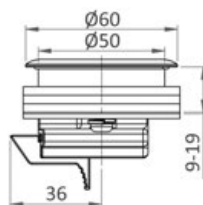

▲ Key for 38.163.02

southco

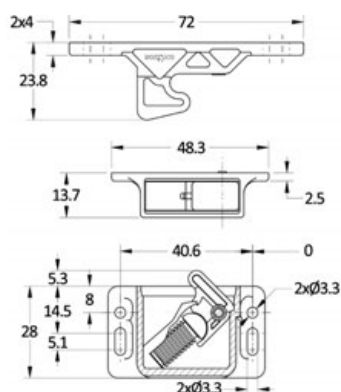

New

Push closure with Grabber hook

The latch closure is facilitated by the use of a mechanism with a relatively low profile (only 13.7 mm thick). The actuation above the dead point firmly compresses the door, releasing the compression upon opening.

Features:

- The latches can be mounted vertically or horizontally, the marks on the latch and the hook are a reference for correct mounting.
- Available in various mounting options: the hook can be installed in front of or beside the frame.
- All models have three clamping forces: 13 N, 22 N and 44 N.
- All models are made of corrosion-resistant materials.

Code	Distance between door hooks in mm.	Approximate pulling force	Colour
38.167.01	40.6	44 N	Black
38.167.02	55	13 N	Blue
38.167.03	55	22 N	Silver
38.167.04	55	44 N	Black

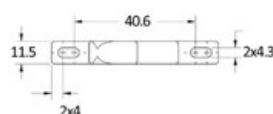

▲ 38.167.01

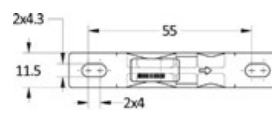

▲ 38.167.02/03/04