

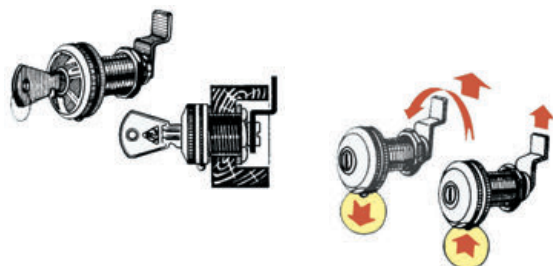

Lever lock with key

Chromed brass, equipped with watertight protection cap, key and double lever. 90° rotation with anti-vibration internal spring.

Code	Neck Ø mm	Neck useful length of fastening mm	Lever travel mm
38.310.50	20	10	13/35



Cylinder lock

90° rotation of the back latch by turning a knurled ring nut under the flange (loose rotation). Press the side button to **lock** the latch. Insert the key to **release** the latch. The advantage is that the lock can always be used without key. Supplied with 3 latches (16/20/25 mm) for different thickness. Made of nickel-plated brass (springs included).

Code	Bore Ø mm	Thread length mm
38.131.70	16	16

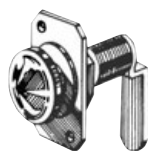

Small rotating latch lock

Made of nickel-plated brass.

Code	Bore Ø mm	Thread length mm
38.131.65	16	16

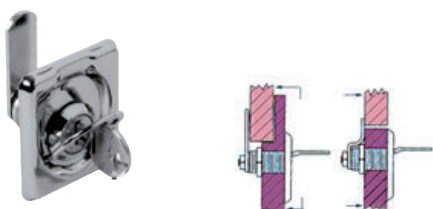

Swivelling lock for portholes and peaks

Made of mirror polished **stainless steel**, fitted with flush handle, fitted with stop lock.

Code	Bore Ø mm	Frontal mm	Thread length mm
38.977.00	16	50x55	20



Hasps and Staples

Locker latch

OSCULATI



Code 38.405.50

Made of **stainless steel**, fitted with spring button and padlock ring hole plate.

Locker latch Deluxe

OSCULATI



Code 38.405.51

Made of **stainless steel**, fitted with checking plate, **faired with hidden screws**.



Hasp & Staple

AISI 316

Made of **precision cast AISI 316 stainless steel**, mirror polished, fitted with **swivelling padlock**.

Code	l mm
38.932.80	75x26 (without strip), 90x26 (with strip)