

2-mm overhang hinges

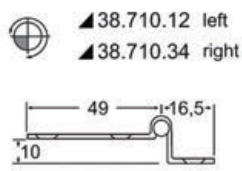

Made of mirror polished stainless steel. Vibration damping by means of a braked central axle.

Code	mm
38.710.12	65,5x37
38.710.34	65,5x37

2-mm overhang hinges

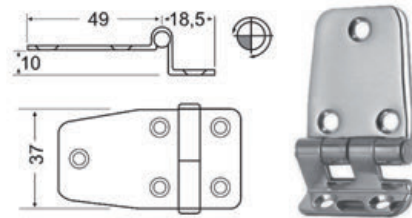

In stainless steel, mirror-polished.

Code	mm
38.441.57	67,5x37

2-mm overhang hinges

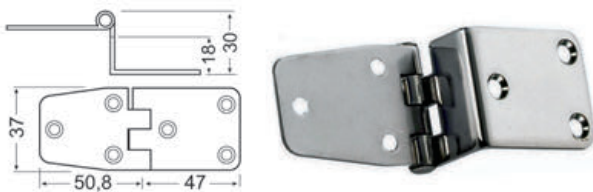

Made of mirror polished stainless steel. Vibration damping by means of a braked central axle.

Code	mm
38.441.84	97,8x37

2-mm overhang hinges

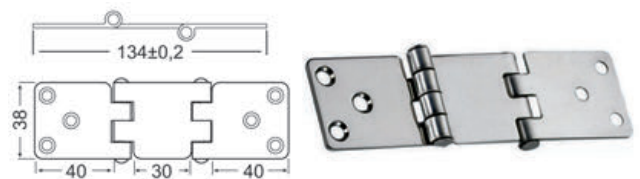

Made of mirror polished stainless steel. Vibration damping by means of a braked central axle.

Code	mm
38.441.82	134x38

Hinges 2 mm thickness foldable

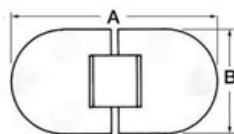

Hinges 2 mm foldable

Made of mirror polished stainless steel. Flush design for folding tables. Fitted with precision-cast central unit.

Code	A mm	B mm
38.460.50	50	38
38.460.76	76	38
38.440.06	84	30



Hinges 2 mm foldable

Made of mirror polished stainless steel. Flush design for folding tables. Fitted with precision-cast central unit.

Code	mm
38.460.79	68x42
38.460.78	70x40

