

SOUND MARINE™



Ultra Slim Speaker

IP65

Ultra-flat, with a recess depth of **only 25 mm**, waterproof **IP65**. Made with the new **CUTTING EDGE** technology that drastically reduces the depth of the cones while ensuring excellent acoustic performance. Minimum distance from the compass: 1 m. Sold individually.

Code	Colour	Ø A mm	Ø B mm	Recess Ø mm	C mm	Power W (cp)		Response frequency Hz	Sensitivity
						Rms	Max		
29.723.03	<input type="checkbox"/> white	180	70	132	25	15	30	70 Hz - 15 KHz	89+- 2 dB

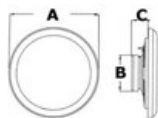

OSCULATI



Pair of two-way amagnetic speakers

AMAGNETICHE/NON-MAGNETIC

WATERPROOF

Non-magnetic models (designed not to disturb instruments or compasses), two-way system (for better performance to highs and lows), fitted with separate tweeter. For indoor and outdoor uses.

Code	Colour	Ø A mm	Ø B mm	C mm	D mm	Power W (torque)		Frequency Hz	Ohm
						Rms	Max		
29.722.00	<input type="checkbox"/> white	180	128	90	60	60	100	60-22000	4

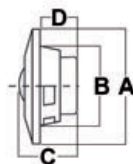

OSCULATI



▲ 29.747.02/04



▲ 29.747.02/04



Pair of two-way speakers with programmable multicolor LEDs

WATERPROOF

UV RESISTANT

LED RGB

2-way loudspeakers with RGB multicolour LED lights programmable by means of the included radio remote control. 2-way loudspeakers offer better bass performance. ABS case and polypropylene diaphragm.

Code	Colour	Power W		Response frequency Hz	Sensitivity dB	←→ mm			
		Rms	Max			D	d1	H	h
29.747.01	<input type="checkbox"/> white	30x2	80x2	80-20000	90	166	121	83	57
29.747.02	<input checked="" type="checkbox"/> Black	30x2	80x2	80-20000	90	166	121	83	57
29.747.03	<input type="checkbox"/> white	50x2	120x2	60-20000	91	192	138	98	65
29.747.04	<input checked="" type="checkbox"/> Black	50x2	120x2	60-20000	91	192	138	98	65



▲ 29.747.01/03

