

### Chromed brass fuel vents with 90° hose adaptor

Fitted with flame-proof screen. Designed in compliance with the requirements of the UNI EN ISO 21487 regulation.

Code	Direction	Hose adaptor Ø mm
20.287.91	Right	16
20.287.92	left	16



▲ 20.284.01; 20.286.01



▲ 20.285.01/03



▲ 20.285.02/04

### Chromed brass flush mount fuel vent

Fuel vents. Designed in compliance with the requirements of the UNI EN ISO 21487 regulation.

90° elbow, right	90° elbow, left	Straight model	Hose adaptor Ø mm
20.285.01	20.285.02	20.284.01	16
20.285.03	20.285.04	20.286.01	20

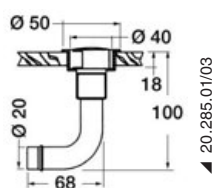

▲ 20.285.01/03

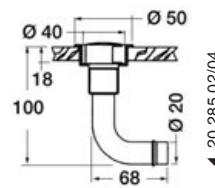

▲ 20.285.02/04



▲ 20.274.16/19

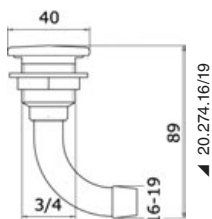

▲ 20.274.16/19

### Full Flush chromed-brass fuel vent

The vent is located in the lower part for a completely closed design. Designed in compliance with the requirements of the UNI EN ISO 21487 regulation.

Model 90°	Straight model	Hose adaptor Ø mm
20.274.16	20.275.16	16
20.274.19	20.275.19	20



▲ 20.275.16/19

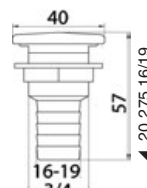

▲ 20.275.16/19

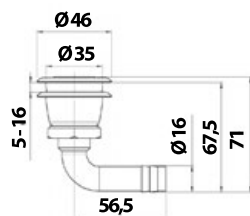

### Flush-mount fuel vent made of stainless steel.

With flame-resistant grid. Designed in compliance with the requirements of the UNI EN ISO 21487 regulation.

Code	Hose adaptor
20.271.02	at 90°



▲ 20.272.01/02



▲ 20.273.01/02

### Cast and mirror polished AISI316 stainless steel fuel vents

Fitted with flame-proof screen, detachable for easy maintenance. Designed in compliance with the requirements of the UNI EN ISO 21487 regulation.

Model 90°	Straight model	for pipe Ø mm	Bulkhead hole mm	Bulkhead thickness mm	Head mm
20.272.02	20.272.01	16	35	7/24	45
20.273.02	20.273.01	19	38	8/27	49