

CEM fresh water pump with bronze body and accumulator tank

Bronze pump unit also suitable for use with **salt water** such as washdown. Stainless steel accumulator tank. Self-priming pump. A check valve needs to be mounted onto the inlet pipe. Fitted with pressure switch and relay.

Code	V	Flow l/min	Motor				Pressure switch calibration BAR	Hose adaptor	Tank l	
			HP	W	revolutions/ min	A				
16.061.24	24	36	0.65	480	3000	22	1.4-2.8	1"	2	25

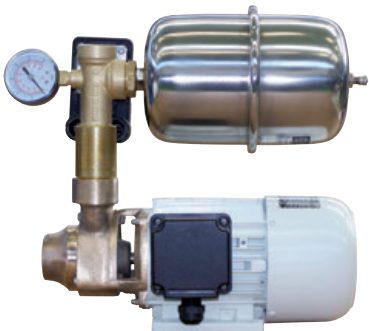
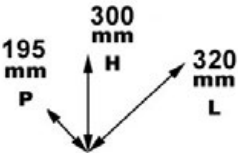

CEM fresh water pump with accumulator tank

Stainless steel pump body. Stainless steel expansion vessel. Self-priming pump, non-return valve on suction recommended. Complete with pressure gauge and relay.

Code	V	Flow l/min	Motor				Maximum pressure BAR	Pressure switch calibration BAR	Hose adaptor	Tank l	
			HP	W	revolutions/ min	A					
16.062.24	24	50	0.8	600	2600	28	4.8	1.4-3.0	1"	20	17

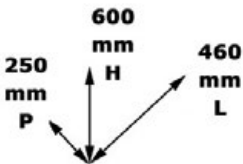

CEM electronically-operated fresh water pump

Stainless steel pump unit. Self-priming pump.
EPC (Electronic Pressure Control) system: automatic pump shutdown when the water reserve is depleted (protecting the pump itself from harmful dry running).
Constant monitoring of operation through indicator lights: green light "Line" = pump in operation; red light = "Failure": pump not in operation due to an anomaly (e.g., water depletion).
Constant water pressure during delivery. Reduced dimensions compared to traditional pressure tanks with a reservoir.

Code	V	Flow l/min	Head m	Motor				Hose adaptor	
				HP	W	revolutions/min	A		
16.064.12	12	55	28	0.4	300	2200	33	1"	7
16.064.24	24	55	30	0.5	400	2600	16	1"	7
16.063.12	12	50	30	0.7	520	2400	40	1"	11.5
16.063.24	24	50	38	0.8	600	2600	28	1"	11.5

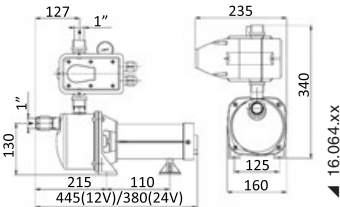
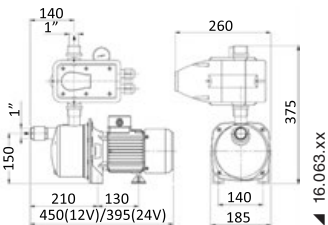

16.063.xx



16.064.xx