



## Europump fresh water pumps

**OSCULATI**

### Europump 4 low-consumption fresh water pump

CE

It can feed 2 taps at the same time. Fitted with circuit breaker against overloads. It can run dry without damage.

UK  
CA

Code	Pressure switch calibrated to	Flow l/min	Current draw A	Hose adaptor Ø mm	Maximum dimensions in mm	Pressure switch spare parts	kg
16.503.12	2,8 BAR/40 PSI	3.8	2	10	170x100x60	16.540.01	0.7



### Europump 4 New Generation fresh water pump

IP 54

It can serve two outlets. Overload protection. It can run dry without getting damaged. IP54 watertight. Self-priming up to 1.5 metres. Pulsation-dampening by-pass system.

CE

Code	V	Current draw A	Flow l/min	Operating pressure bar	Snap hose holder mm	kg
16.501.12	12	4.5	5.6	2.8	10	0.7

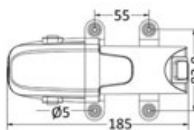

### Europump 3-diaphragm self-priming fresh water pump

CE

It can run dry without damage, no vibrations, very quiet. Fitted with internal bypass for inlet pressure control. Permanent magnet motor with self-lubricating shaft. Circuit breaker against unwanted overheating.

**4 plug-in fittings** (2 x 1/2" threads + 1 x 14-mm straight hose adaptor + 1 x 14-mm 90° hose adaptor) and **plug-in inlet strainer**,

UK  
CA

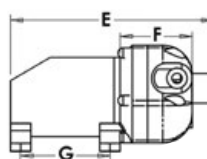
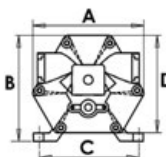

Code	Type	V	Flow l/min	Current draw A	Operating pressure of the bar	mm							Spare parts		kg
						A	B	C	D	E	F	G	pressure switch	Filter	
16.509.12	Europump "8"	12	8	5	2	110	106	77	98	240	85	59	16.540.03	16.533.01	2
16.510.12	Europump "11"	12	11	6	3	110	106	77	98	240	85	59	16.540.04	16.533.01	2