

Battery switches and battery isolators

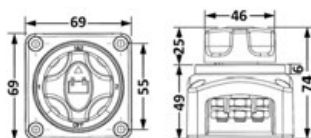

Battery switch

Switch positions: Batt. 1 - Batt. 2 - Batt. 1+2 - OFF.
12/24 V voltage.

Code	Max capacity A 50V DC			Ø pins mm	↔ mm
	for 30 sec.	in continuous	intermittent		
14.923.12	1000	100	300	10	69x69x74 h

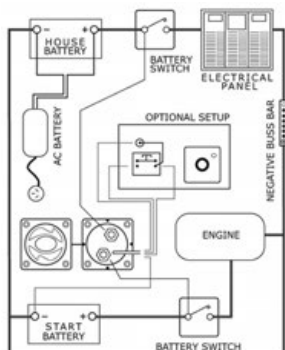

Dual operation voltage-sensitive switch and emergency parallel

This Voltage Sensitive Switch (VSS) automatically senses the voltage of two connected batteries or battery banks and provides optimal, efficient charging of the second bank.

The VSS allows for two independent battery banks to be combined or isolated based on the presence of a charging source (such as an engine alternator or battery charger).

Once the charging source is activated, the VSS lets the first battery of the main bank (engine battery) recharge; when this latter reaches 13.2V, the switch opens the circuit and lets the second battery (service battery) recharge.

The emergency parallel function can be operated manually by means of a knob or through an On/Off button on the dashboard.

Recess or surface mounting.



▲ 14.386.09

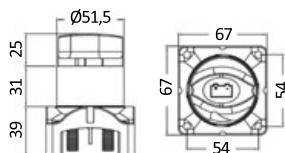

Code	V	Max capacity A		↔ mm
		intermittent	in continuous	
14.386.10	12	455	275	67x67x95

14.386.09 OPTIONAL ON-OFF 12V switch with double key and LED warning light. Dimensions: 69x69x45 mm.

Selecta New battery switch

IP65



Can use batteries alternatively or simultaneously; fitted with **copper** contacts, **stainless steel** springs, **PC/PTB/Fiberglass** flame resistant casing, protective cable base; extra ring-nut for flush mounting (Ø size 95 mm); type approved by ISO 8846 MARINE EN 28846. A) "MK II" version. selectable options: bank/battery "1", bank/battery "2" or 1+2 simultaneously. Includes device that disconnects the alternator power automatically if is under the "OFF" position without switching off the engines; type-approval no. DIP006907SP. B) Version MK III. connects the engine start-up batteries and the service batteries simultaneously in position "1", keeping the start-up batteries separately with motors, thus minimizing the risk of an accidental discharge if case of an emergency. The two circuits are connected **among them** under position "2", type-approval no. DIP006907SP.



▲ 14.921.02



▲ 14.921.00

Code	Model	Max capacity A		Functions	Pick up	Base mm	Height mm	Pins mm
		intermittent	in continuous					
14.921.00	MK II	450	300	OFF - 1 - battery 1; 2 - battery 2; 3 - parallel	1500°	104x104	80	10
14.921.02	MK III	450	300	OFF - 1 - Connect services and engines with separate circuits 2 - Parallel between services and engines	1500°	104x104	80	10



▲ Flush mounting ring

▲ 14.921.00

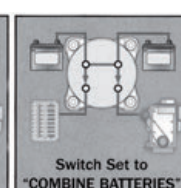
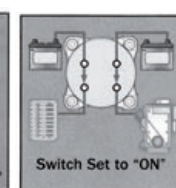
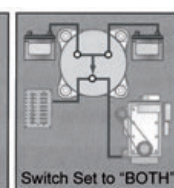
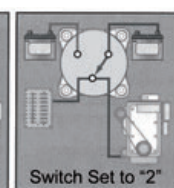
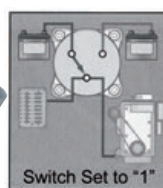

▲ MK II

▲ MK III

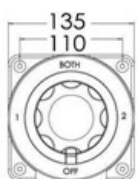

Selecta battery switch



It allows to use one or both batteries or to disconnect them; fitted with safety clip-on lock rotator. CE type-tested in compliance with 94/25/CE standard.

Code	Capacity in continuous	Pins mm	↔ mm
14.920.00	175 A at 12/24V	10	135x135x75H