



10.600.02



10.600.01



10.600.04

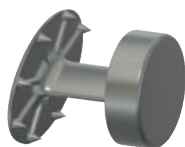

10.600.03

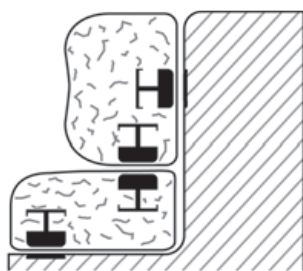

10.600.01-10.600.02



Installation

Magnetic and invisible anchoring system for cushions FOAM ANCHOR®

FOAM ANCHOR® is an intuitive and flexible anchoring system, its installation is very simple and makes any foam cushion magnetic.

The FOAM ANCHOR® system consists of a powerful magnetic attachment designed to be inserted / embedded inside the foam layer of nautical cushions.

Once the magnet has been inserted into the foam, the cushion can be attached to any surface that attracts the magnet (FOAM ANCHOR® plates, another cushion with FOAM ANCHOR® or metal bars).

The magnetic stainless steel plate that comes with the kit includes a 3M double-sided adhesive disc; in case of need for screw fixing, the plate is equipped with two 4 mm side holes.

FOAM ANCHOR® can be used to fix cushions to fixed surfaces such as benches or backrests (10.600.02), but it is also the ideal solution for hooking cushions together (10.600.01), preventing them from moving when you are sitting or lying.

The holding capacity of the "bare" magnet is 11 kg, while the holding capacity with a typical medium installation is 4/5 kg.

The number of magnets to be installed can be chosen based on the desired degree of resistance.

Illustrative scheme		
Boat area	Recommended anchorage quantity	
inside	2	
Bilge	4	
Bow	6	

Code	Description	Type of use
10.600.01	2 magnetic anchors (positive/negative)	Connect two pillows together
10.600.02	1 magnetic anchor plus adhesive magnetic anchor stainless steel plate or for 4 mm screws	Attach the cushion to bulkhead/bench/deck
10.600.03	1 magnetic anchor	-
10.600.04	Adhesive magnetic anchor stainless steel plate or for 4 mm screws	-

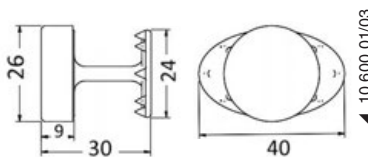

10.600.01/03

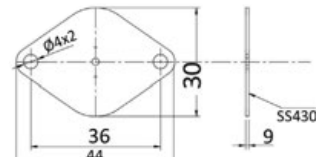

10.600.04



DELAHOUSSE Quick Fit panel fastening system

Hidden and easy fastening, no special tools required.

Usable on wood, metal, and resin panels.

Available with or without seals.

Material: PA6 (black nylon).

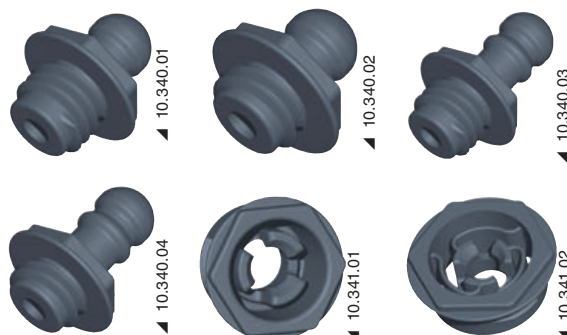

10.340.01

10.340.02

10.340.03

10.340.04

10.341.01

10.341.02

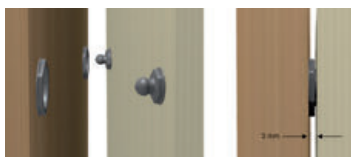

10.340.04 Standard Installation



10.341.03



*They can be mounted flush by creating a recess of 2.5 mm depth in a panel that is 25/32 mm thick.

10.342.00 Marking pin to be used on the back of the panel for mounting without taking measurements.

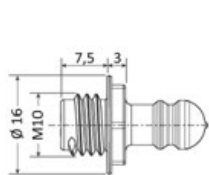

10.340.03

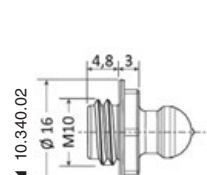

10.340.02

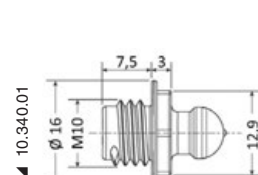

10.340.01

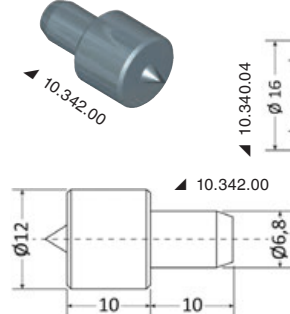

10.342.00

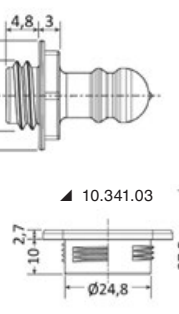

10.341.03

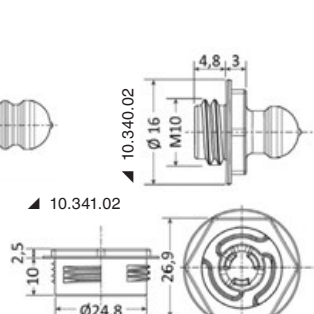

10.341.02

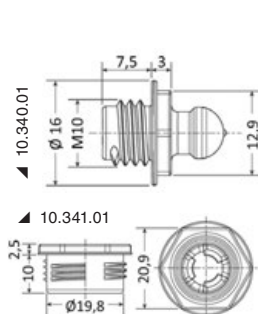

10.341.01