

LEWMAR spare parts for 3-speed winches

Code	Type of spare part
68.955.01	Spring ring third speed (4)
68.955.02	Stainless steel pin for third speed engagement (2)
68.955.03	return spring for the pin (3)
68.955.04	Sealing spring of the ring (5)
68.955.05	Third speed engagement button (1)
68.955.06	Internal fixing pin for the seal spring (6)

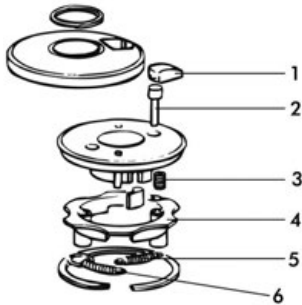

LEWMAR stripper ring for Evo winches

Only for Evo series winches produced from 2011 on (item 5 on drawing “What’s inside a LEWMAR winch?”).

Code	Type
68.957.01	Evo 15
68.957.02	Evo 30 / 40
68.957.03	Evo 45
68.957.04	Evo 50



Lewmar Winch Handles

LEWMAR standard ball bearing handle

Available in various versions, materials, and lengths. Available in anodized aluminum and chromed bronze.

Length mm		Model
200	250	
68.201.20	68.201.25	Made of aluminium, fitted with lock
-	68.211.25	Made of chromed bronze, fitted with lock



LEWMAR OneTouch ball bearing handle

DAME
AWARD 2006

The patented and innovative OneTouch mechanism allows to lock in and remove the winch handle with one hand. Simply squeeze the release lever, which runs the entire length of the handle, and pull to unlock in one quick and easy motion. Available in PowerGrip version to make two-handed grip easier when subjected to maximum stress.

Code	Length mm	Model
68.221.25	250	Aluminium
68.222.25	250	aluminium, with PowerGrip



LEWMAR winch handle pocket

Code 68.201.00

Made of UV-resistant PVC, it is highly weatherproof. Rear bulkhead mounting and drain.



LEWMAR Titan floating winch handle

The Titan floating winch handle has been designed to combine lightweight and resistance to saltwater environments. Made with high quality materials. Available in two versions: Primary floating handle for pleasure boats and Magnum ball bearing handle for racing boats.

Length mm		Description	Colour
Primary 200	Magnum 250		
68.231.20	68.231.25	Primary with lock	red

