

Exhaust pipes



Exhaust pipe scuppers

Made of **neoprene and stainless steel**, universal size, anti-vibration, rust-proof.

Code	Ø mm
51.381.01	40
51.381.02	50/60
51.381.03	75/90



Exhaust protection valves

Made of **rubber**, fitted with **stainless steel** clamp, for mounting on the exhaust terminals in order to avoid water from returning in case of quick shut down, **sold in pairs**.

Code	Type	Maximum Ø mm
51.381.99	2"	52
51.382.00	3"	75
51.382.01	4"	100
51.382.02	6"	150

OSCULATI



Exhaust pipe scuppers fitted with anti-backflow check valve

AISI 316

Made of **mirror polished AISI 316 stainless steel**, fitted with rubber anti-backflow check valve. Fastening with 4 folding studs 6mm-Ø.

Code	Ø pipe mm	Ø flange mm	Ø net opening mm	Neck length mm
51.384.01	40	75	35	75
51.384.02	45	75	40	75
51.384.03	50	100	45	80
51.384.04	60	100	55	80
51.384.06	75	131	67	100
51.384.07	90	131	73	110
51.384.08	100	182	90	120
51.384.09	110	182	100	120
51.384.10	125	182	113	140

OSCULATI

Technopolymer and stainless steel exhaust pipe scuppers with check valve

Made of reinforced technopolymer with polished AISI304 stainless steel finish ring. Hidden screws. Easy mounting. Stainless steel full design.

Code	For hose Ø mm	←→ mm				
		A	B	C	D	E
51.386.01	40	41	60	30	85	65
51.386.02	45	46	60	30	85	65
51.386.03	50	51	60	30	85	65
51.386.04	60	61	90	35	110	89.5
51.386.06	75	76	90	35	110	89.5
51.386.07	90	91	90	45	138	116
51.386.08	100	101	90	45	138	116
51.386.09	110	111	110	50	165	141
51.386.10	125	126	110	50	165	141

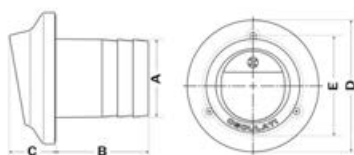

Polished AISI316 stainless steel finish ring

Non return flap made from NBR

Hidden screws

Heat resistant

Easy fast mounting